

MB21/1 XL Connector

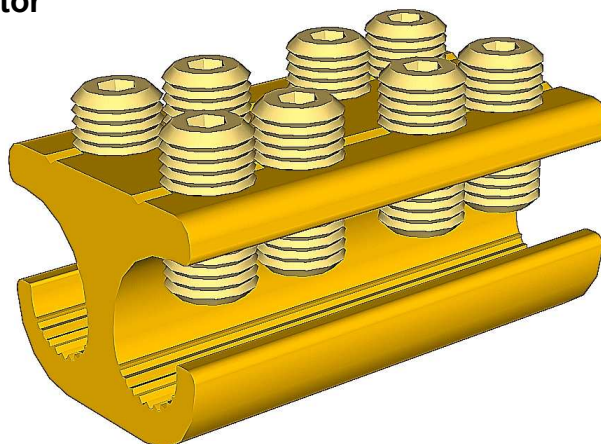

Principle Application:

Stranded and solid shaped service conductors.

Range:

Product Reference	Type	Core c.s.a. (mm ²)	
		Min	Max
MB21/1 XL	Branch	4*	35

Note: For jointing other core configurations/sizes please contact Sicame Technical Dept

The **Hepworth MB21** mechanical connector is designed for branch connections on stranded or solid cable. The ferrules are manufactured in brass for suitability of jointing both aluminium and copper conductor cores.

Secondary Application:

Stranded and solid circular conductors.

Product Reference	Type	Core c.s.a. (mm ²)	
		Min	Max
MB21/1 XL	Branch	4*	35

Note: For jointing other core configurations/sizes please contact Sicame Technical Dept

MB21/1 XL Connector

Physical Dimensions

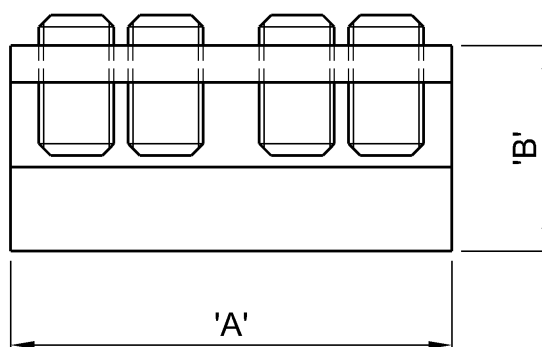
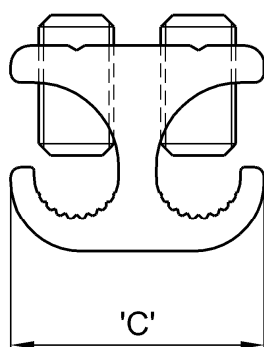
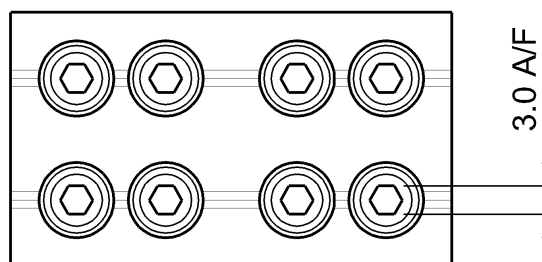

Connector Reference	Dimensions (mm)		
	'A'	'B'	'C'
MB21/1 XL	47.0	22.0	27.0

Material:

Copper Alloy

Test Specification:

IEC1238-1. Test Report No: TTR/267 and 275

Fitting Instructions:

1. Cut the cables to length and strip the core insulation equal to the length of the connector +3mm.
2. Thoroughly abrade all conductors to be jointed.
3. Align cores within connector and tighten screws on each side of the connector consecutively, until tight.

Note:

* Conductor cores 4mm² and below should be doubled, and if necessary doubled again, to achieve the necessary cross-sectional area.